

MOTORSPORT PARK HASTINGS
HASTINGS, NEBRASKA
PROPOSED GRADING PLAN

U.S. HIGHWAY #6

FUTURE COMMERCIAL
AND LIGHT INDUSTRIAL
DEVELOPMENT AREA

Future
Drag Race
Complex

UNION PACIFIC RAILROAD

SHOWBOAT BLVD.

MISSOURI PACIFIC RAILROAD (ABANDONED)

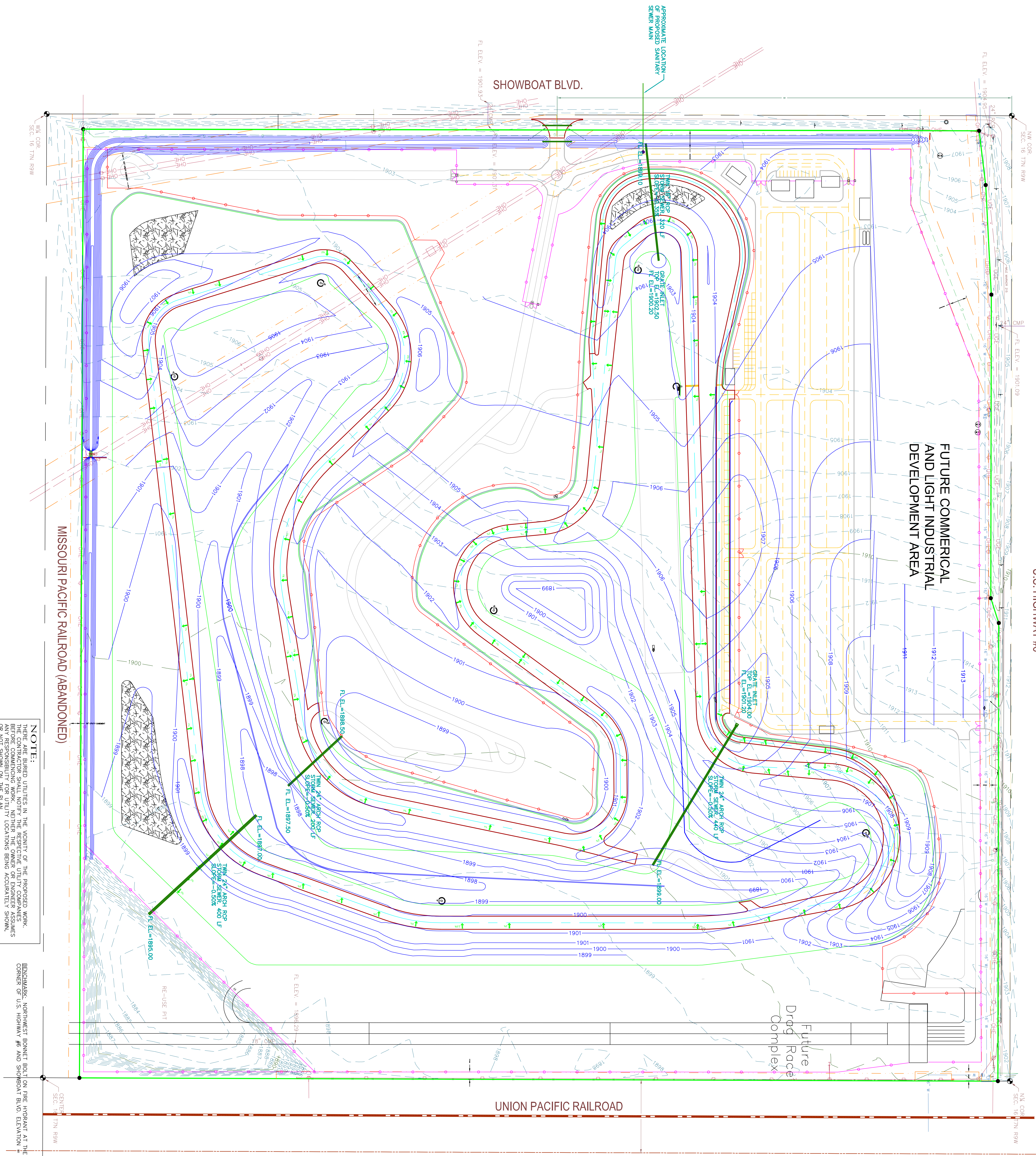

NOTE:
THESE ARE BORED UTILITIES IN THE VICINITY OF THE PROPOSED WORK. THE ENGINEER HAS CONDUCTED VISUAL INSPECTIONS AND RECORDS ANY RESPONSIBILITY FOR UTILITY LOCATIONS BEING ACCURATELY SHOWN ON THIS DRAWING IS THE OWNER'S.

REMARKS: NORTHWEST CORNER BOLT ON FIRE HYDRANT AT THE SOUTHWEST CORNER OF U.S. HIGHWAY #6 AND SHOWBOAT BLVD. ELEVATION = 1909.25

LEGEND	
●	SECTION CORNER
○	PROPERTY CORNER
—	PIPE
—	WATER MAIN
—	REINFORCED CONCRETE PIPE
—	OVERHEAD ELECTRIC LINE
—	FENCE
—	CONTOUR LINE
—	WATER MAIN
—	FIBER OPTIC LINE
—	GAS MAIN
—	WATER MAIN
—	CONTOUR LINE
—	DIRT ROAD EDGE
—	TRACK EDGE
—	EDGE OF PAVING
—	EDGE OF SAFETY ZONE
—	GUARDRAIL - 3 ROW
—	GUARDRAIL - 2 ROW
—	FENCE - 4 FT
—	FENCE - 6 FT
—	STRIPE
—	ISLAND CORNER POST
—	CORNER POST
—	GRAVEL TRAP
—	BUILDING

